

ASSEMBLING INSTRUCTIONS

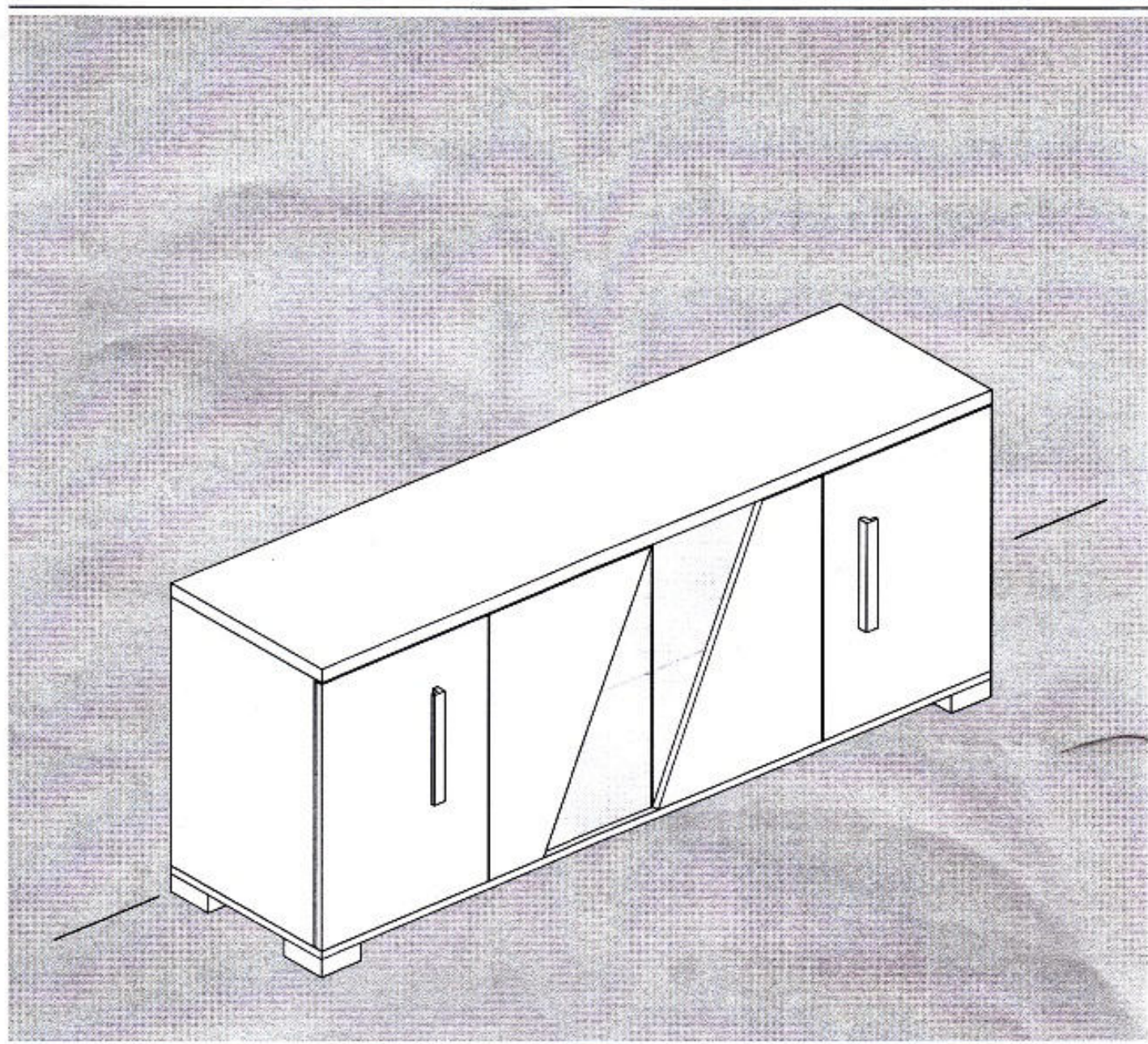

**4/D BUFFET
MOD. LISA**

- 1 Bottom
- 2 Feet
- 3 Lateral side
- 4 Central side
- 5 Lateral back panel
- 6 Central back panel
- 7 Top
- 8 Lateral glass shelf
- 9 Central glass shelf
- 10 Lateral Door
- 11 Central Door
- 12 Handle

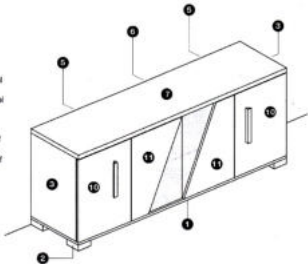

FITTING CHECK LIST



5 Wooden dowels



6 Screw for feet



7 Pins



8 Shelf support



9 Cambs



10 Back panel stopper



11 Cap for cambs

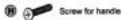

12 Screw for handle

FOR SIDE FITTINGS CHECK LIST



FOR DIVISION FITTINGS CHECK LIST



HINGES

A Lateral Hinge

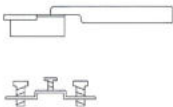
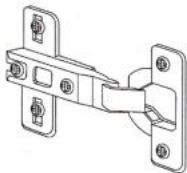

B Central Hinge

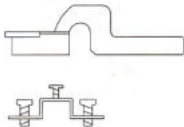
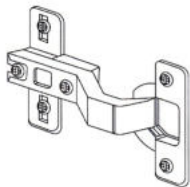

1

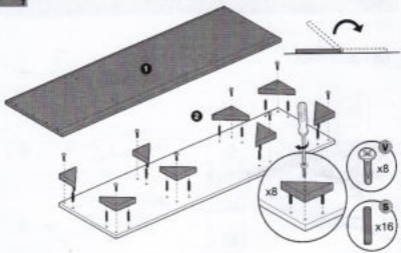

2

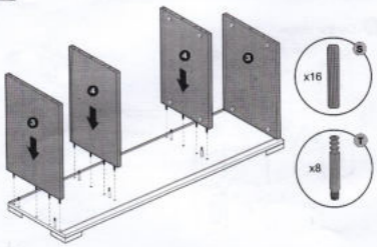

3

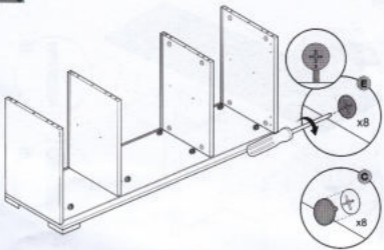

4

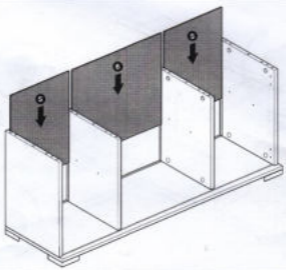

STEP 5

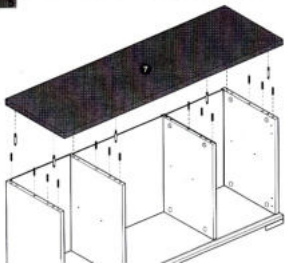

STEP 6

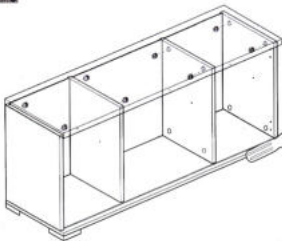

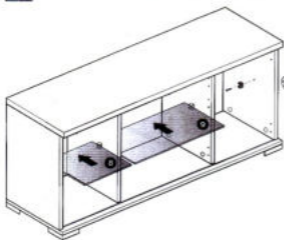
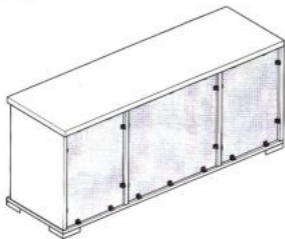

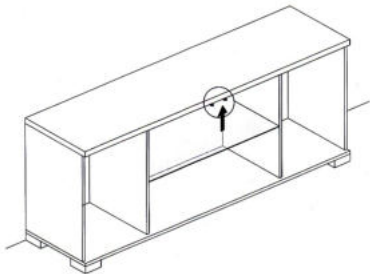
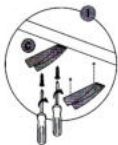

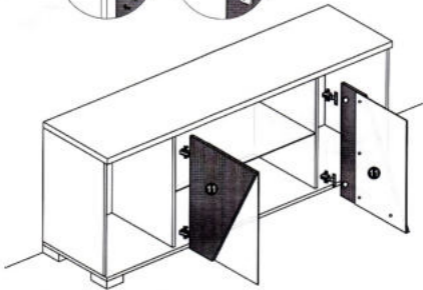
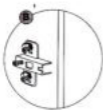

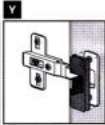
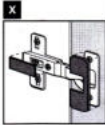
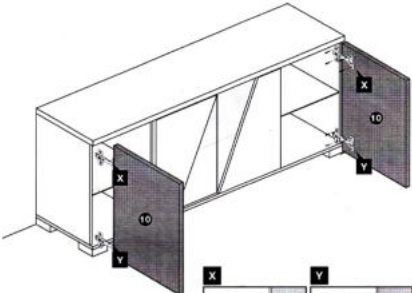
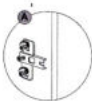

**PUSH PULL SYSTEM
CENTRAL DOOR**



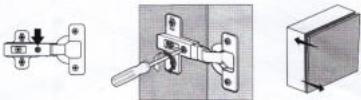
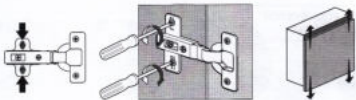

X

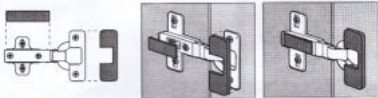

Y

